

**DESIGN REPORT**

- Legend:**
- City Boundary
  - Proposed Development Boundary
  - Proposed Road Development
  - Earthworks - Fill
  - Earthworks - Cut
  - Structure
  - Proposed Retaining wall / Earth Retention
  - Proposed Culvert
  - Proposed Environmental Underpass
  - Proposed Mammal Green Overbridge
  - Proposed Attenuation Pond / Infiltration Basin / Wetlands
  - Proposed Stream Diversion

San áiríamh tá sonraíocht Shuirbhíreacht Orlándaís Éireann arna áitirgeadh faoi Cheadúnas OSI Uimh. 2010/18CCMA/Comhairle Contae na Gaillimhe. Sárúim ar áitirgeadh neamhdáraithe cóipeacht Shuirbhíreacht Orlándaís Éireann agus Rialtas na hÉireann. © Suirbhíreacht Orlándaís Éireann, 2010.

© Suirbhíreacht Orlándaís Éireann. Gach ceart ar chosaint. Uimhir cheadúnais 2010/18CCMA/Comhairle Contae na Gaillimhe.

Includes Ordnance Survey Ireland data reproduced under OSI Licence number 2010/18CCMA/Galway County Council. Unauthorised reproduction infringes Ordnance Survey Ireland and Government of Ireland copyright. © Ordnance Survey Ireland, 2010.

© Ordnance Survey Ireland. All rights reserved. Licence number 2010/18CCMA/Galway County Council.

**Clients**

**Key Plan**

**Consultant**

Corporate House  
City East Business Park  
Ballybrit, Galway, Ireland.

Tel +353 (0)91 460675  
www.N6GalwayCity.ie  
www.arup.ie

**Job Title**  
N6 Galway City Ring Road

**Scale**  
1:5000 @ A3

**Date:**  
February 2018

Issue	Date	By	Chkd	Appd
11	22/02/2018	KJ	MG	EMC

**Drawing Title**  
Proposed Road Development Plan  
CH.0+000 to CH.1+350  
Sheet 1 of 15

**Drawing Status**  
For Information

Job No	Drawing No	Issue
233985	GCOB-100-D-001	11

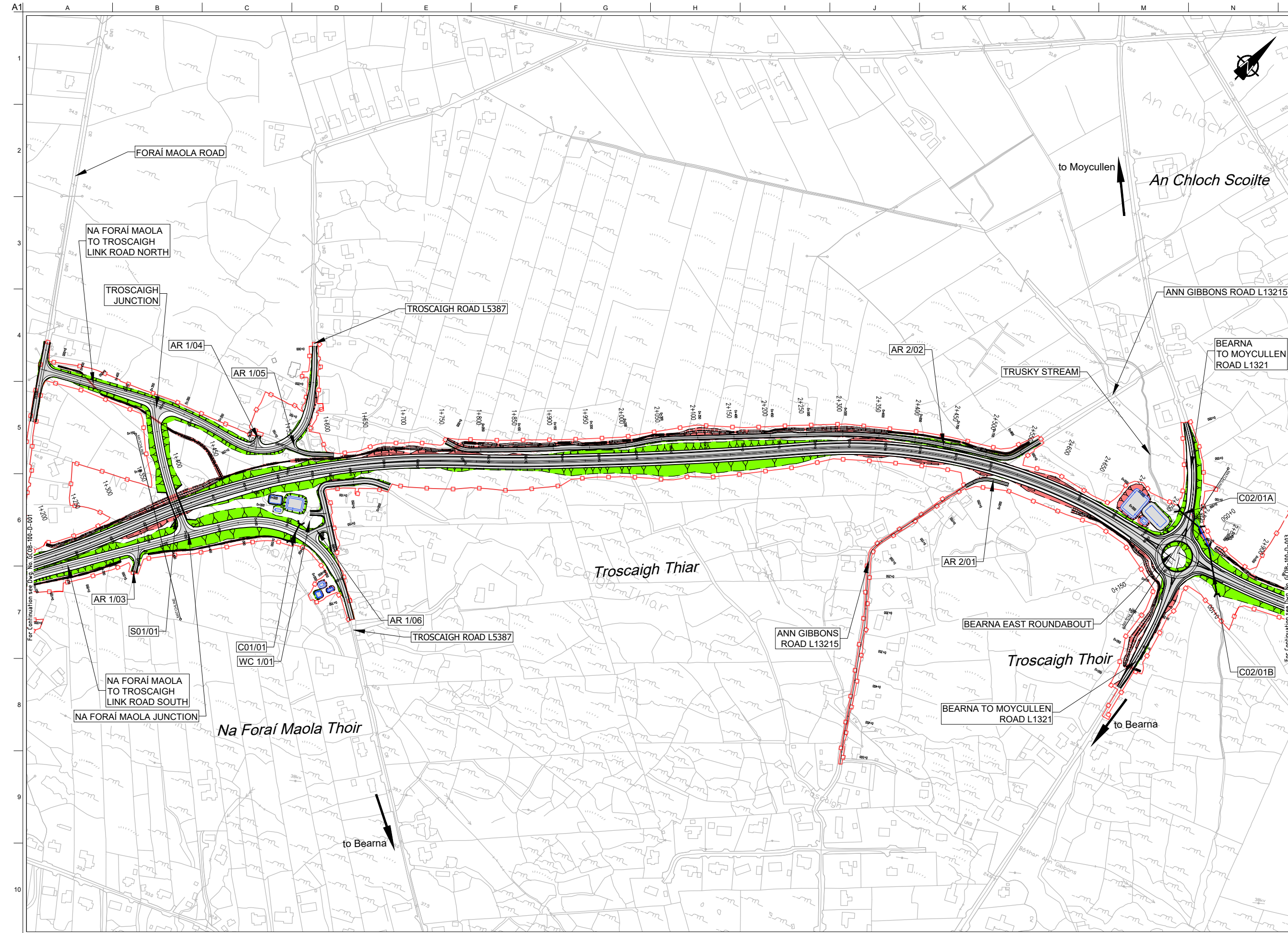

**DESIGN REPORT**

- Legend:**
- City Boundary
  - Proposed Development Boundary
  - Proposed Road Development
  - Earthworks - Fill
  - Earthworks - Cut
  - Structure
  - Proposed Retaining wall / Earth Retention
  - Proposed Culvert
  - Proposed Environmental Underpass
  - Proposed Mammal Green Overbridge
  - Proposed Attenuation Pond / Infiltration Basin / Wetlands
  - Proposed Stream Diversion



San áireamh tá sonraíochtaí Shairbhíreachtúcháin Orlándaí Éireann arna áitirgeadh faoi Cheadúnas OSI Uimh. 2010/18CCMA/Comhairle Contae na Gaillimhe. Sáráilom áitirgeadh na mbeathúcháin na císcheart Shairbhíreachtúcháin Orlándaí Éireann agus Rialtas na hÉireann. © Shairbhíreachtúcháin Éireann, 2010.

© Shairbhíreachtúcháin Éireann. Gach ceart ar chosaint.  
Uimhir cheadúnais 2010/18CCMA/Comhairle Contae na Gaillimhe.

Includes Ordnance Survey Ireland data reproduced under OSI Licence number 2010/18CCMA/Galway County Council.  
Unauthorised reproduction infringes Ordnance Survey Ireland and Government of Ireland copyright. © Ordnance Survey Ireland, 2010.

© Ordnance Survey Ireland. All rights reserved. Licence number 2010/18CCMA/Galway County Council.

Clients

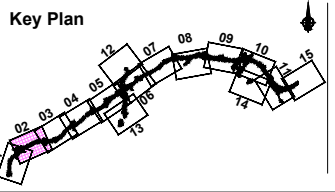

Consultant

Corporate House  
City East Business Park  
Ballybrit, Galway, Ireland.

Tel +353 (0)91 460675  
www.N6GalwayCity.ie  
www.arup.ie

Job Title  
**N6 Galway City Ring Road**

Scale  
1:5000 @ A3

Date:  
February 2018

Issue	Date	By	Chkd	Appd
11	22/02/2018	KJ	MG	EMC

Drawing Title  
Proposed Road Development Plan  
CH.1+350 to CH.2+799  
Sheet 2 of 15

Drawing Status  
**For Information**

Job No <b>233985</b>	Drawing No <b>GCOB-100-D-002</b>	Issue <b>11</b>
-------------------------	-------------------------------------	--------------------

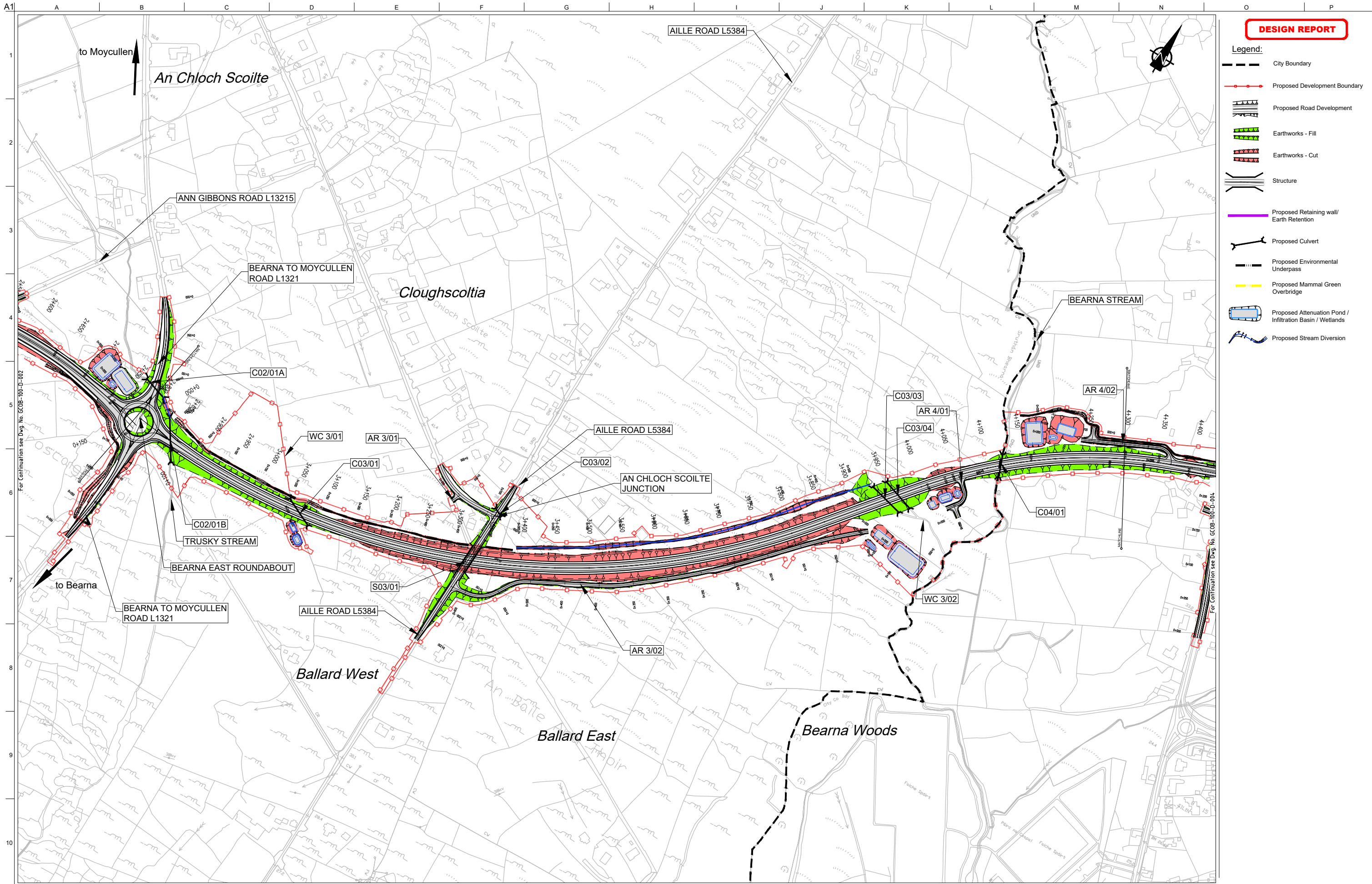

**DESIGN REPORT**

- Legend:**
- City Boundary
  - Proposed Development Boundary
  - Proposed Road Development
  - Earthworks - Fill
  - Earthworks - Cut
  - Structure
  - Proposed Retaining wall/ Earth Retention
  - Proposed Culvert
  - Proposed Environmental Underpass
  - Proposed Mammal Green Overbridge
  - Proposed Attenuation Pond / Infiltration Basin / Wetlands
  - Proposed Stream Diversion

San áiríamh tá sonraíochtaí Shairbhíreacht Orlándaís Éireann arna aistriú go dtailíú físiúil Cheadúnas OSI Uimh. 2010/18CCMA/Comhairle Contae na Gaillimhe. Sárúilom aistriú go dtailíú na cíoscheart Shairbhíreacht Orlándaís Éireann agus Rialtas na hÉireann. © Sairbhíreacht Orlándaís Éireann, 2010.

© Sairbhíreacht Orlándaís Éireann. Gach ceart ar chosaint. Uimhir cheadúnais 2010/18CCMA/Comhairle Contae na Gaillimhe.

Includes Ordnance Survey Ireland data reproduced under OSI Licence number 2010/18CCMA/Galway County Council. Unauthorised reproduction infringes Ordnance Survey Ireland and Government of Ireland copyright. © Ordnance Survey Ireland, 2010.

© Ordnance Survey Ireland. All rights reserved. Licence number 2010/18CCMA/Galway County Council.

**Clients**

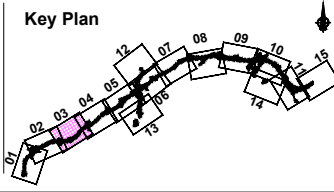

**Consultant**

Corporate House  
City East Business Park  
Ballybrit, Galway, Ireland.

Tel +353 (0)91 460675  
www.NGalwayCity.ie  
www.arup.ie

**Job Title**  
N6 Galway City Ring Road

**Scale**  
1:5000 @ A3

**Date:**  
February 2018

Issue	Date	By	Chkd	Appd
11	22/02/2018	KJ	MG	EMC

**Drawing Title**  
Proposed Road Development Plan  
CH.2+799 to CH.4+300  
Sheet 3 of 15

**Drawing Status**  
For Information

<b>Job No</b> 233985	<b>Drawing No</b> GCOB-100-D-003	<b>Issue</b> 11
-------------------------	-------------------------------------	--------------------

**DESIGN REPORT**

- Legend:**
- City Boundary
  - Proposed Development Boundary
  - Proposed Road Development
  - Earthworks - Fill
  - Earthworks - Cut
  - Structure
  - Proposed Retaining wall / Earth Retention
  - Proposed Culvert
  - Proposed Environmental Underpass
  - Proposed Mammal Green Overbridge
  - Proposed Attenuation Pond / Infiltration Basin / Wetlands
  - Proposed Stream Diversion

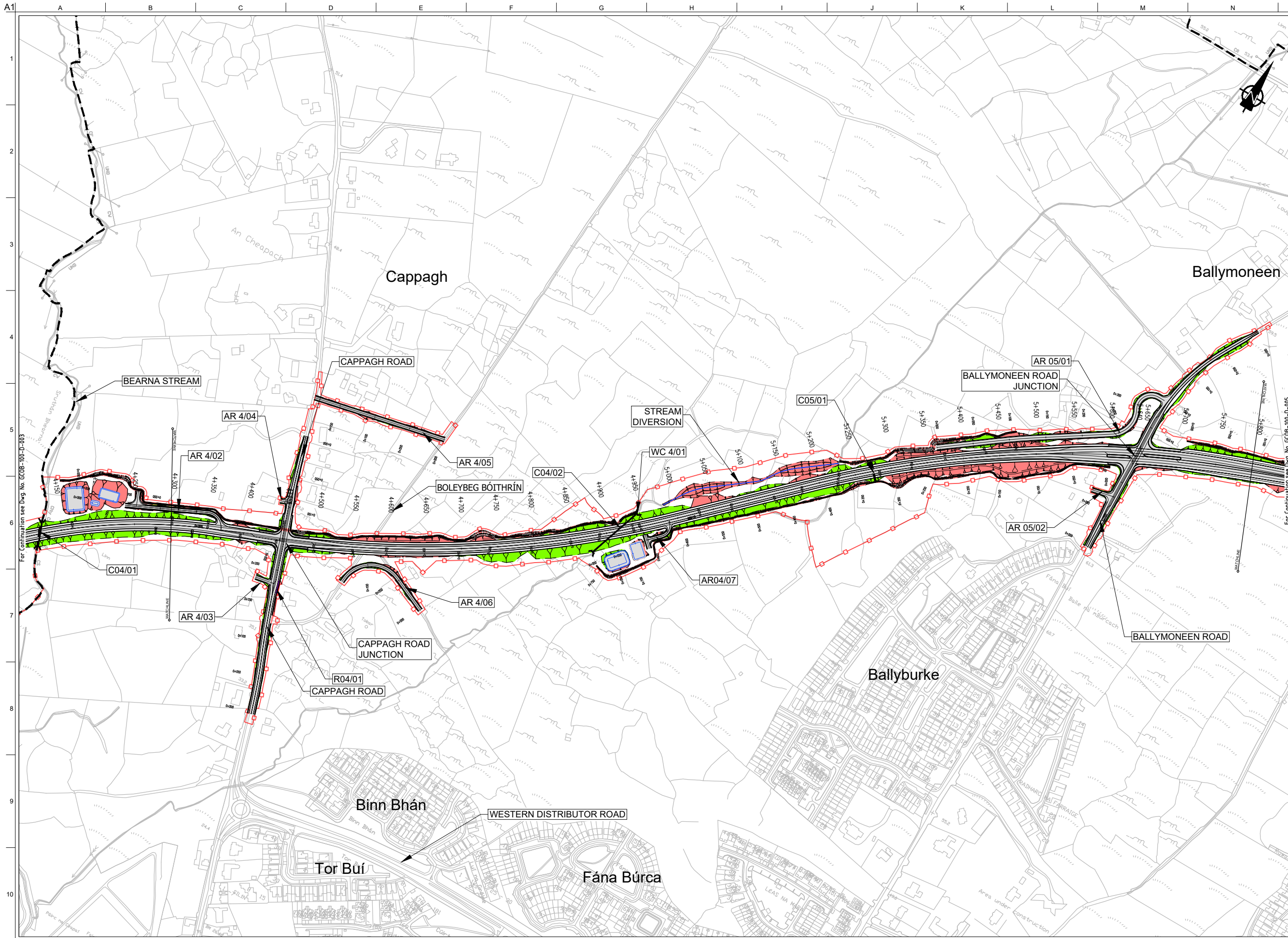

Son áiríamh tá sonraíocht Shairbhíreacht Orlánais Éireann arna aistriú go dtailíú físiúil Cheadúnas OSI Umh. 2010/18CCMA/Comhairle Contae na Gaillimhe. Sárúim ar aistriú go dtailíú físiúil Cheadúnas OSI Umh. 2010/18CCMA/Comhairle Contae na Gaillimhe. © Sairbhíreacht Orlánais Éireann, 2010.

© Sairbhíreacht Orlánais Éireann. Gach ceart ar chosaint.  
Umhír cheadúnas 2010/18CCMA/Comhairle Contae na Gaillimhe.

Includes Ordnance Survey Ireland data reproduced under OSI Licence number 2010/18CCMA/Galway County Council.  
Unauthorised reproduction infringes Ordnance Survey Ireland and Government of Ireland copyright. © Ordnance Survey Ireland, 2010.

© Ordnance Survey Ireland. All rights reserved. Licence number 2010/18CCMA/Galway County Council.

Clients

Comhairle Contae na Gaillimhe  
Galway County Council

An Roinn Iompair  
Turasóireachta agus Spóirt

TII

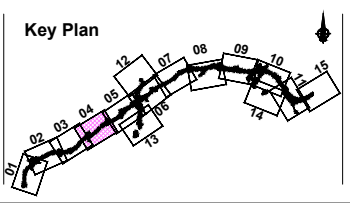

Consultant

Corporate House  
City East Business Park  
Ballybrit, Galway, Ireland.

Tel +353 (0)91 460675  
www.N6GalwayCity.ie  
www.arup.ie

Job Title  
**N6 Galway City Ring Road**

Scale  
1:5000 @ A3

Date:  
February 2018

Issue	Date	By	Chkd	Appd
11	22/02/2018	KJ	MG	EMC

Drawing Title  
**Proposed Road Development Plan  
CH.4+300 to CH.5+800  
Sheet 4 of 15**

Drawing Status  
**For Information**

Job No <b>233985</b>	Drawing No <b>GCOB-100-D-004</b>	Issue <b>11</b>
-------------------------	-------------------------------------	--------------------

**DESIGN REPORT**

- Legend:**
- City Boundary
  - Proposed Development Boundary
  - Proposed Road Development
  - Earthworks - Fill
  - Earthworks - Cut
  - Structure
  - Proposed Retaining wall / Earth Retention
  - Proposed Culvert
  - Proposed Environmental Underpass
  - Proposed Mammal Green Overbridge
  - Proposed Attenuation Pond / Infiltration Basin / Wetlands
  - Proposed Stream Diversion

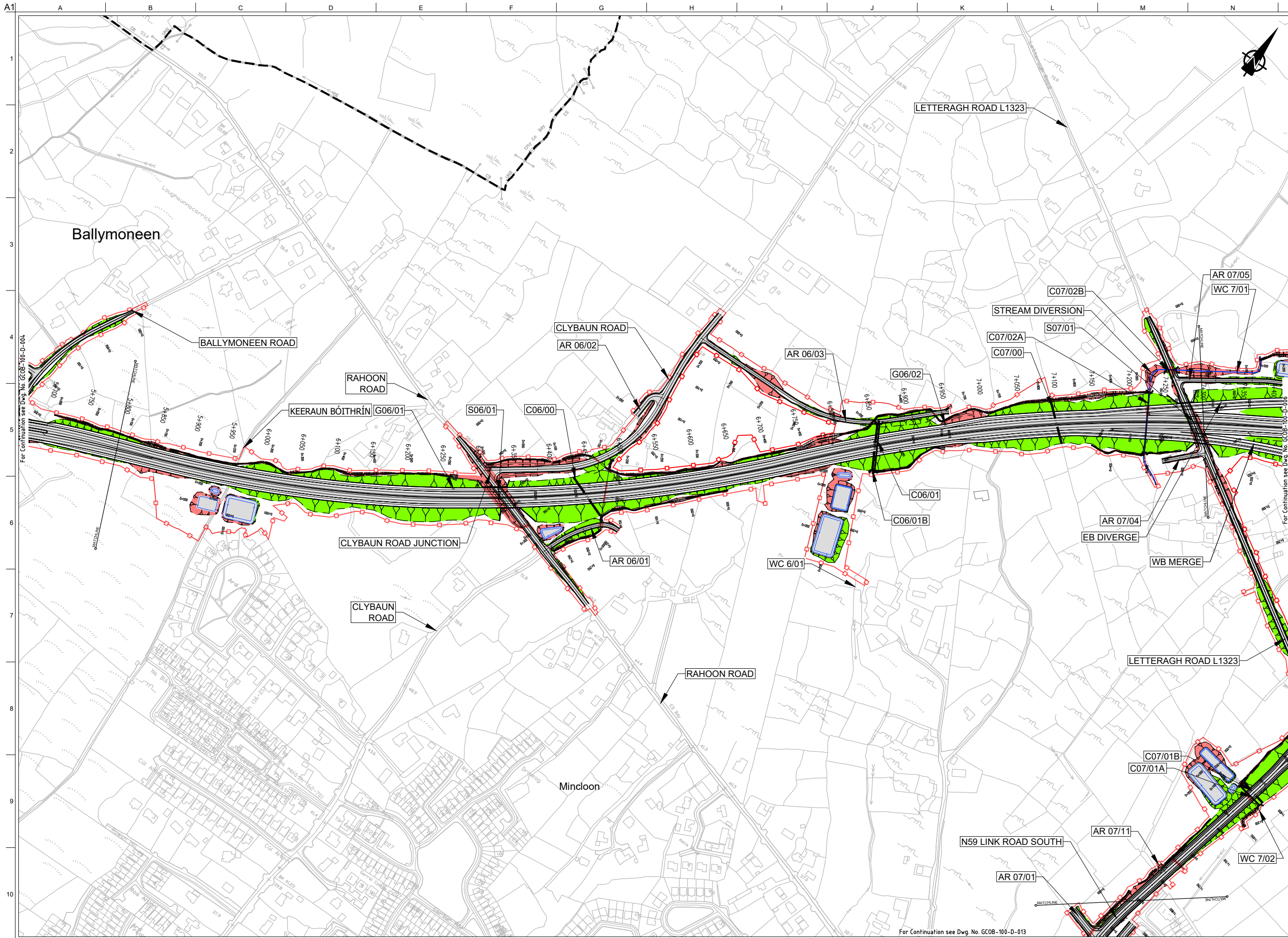

San áiríamh tá sonraíochtaí Shairbhéiríochtaí Ordánais Éireann arna áitirgeadh faoi Cheadúnas OSI Uimh. 2010/18CCMA/Comhairle Contae na Gaillimhe. Sárúilom áitirgeadh na mbhídaraithe cíoscheart Shairbhéiríochtaí Ordánais Éireann agus Rialtas na hÉireann. © Sairbhéiríochtaí Ordánais Éireann, 2010.

© Sairbhéiríochtaí Ordánais Éireann. Gach ceart ar chosaint.  
Uimhir cheadúnais 2010/18CCMA/Comhairle Contae na Gaillimhe.

Includes Ordnance Survey Ireland data reproduced under OSI Licence number 2010/18CCMA/Galway County Council.  
Unauthorised reproduction infringes Ordnance Survey Ireland and Government of Ireland copyright. © Ordnance Survey Ireland, 2010.

© Ordnance Survey Ireland. All rights reserved. Licence number 2010/18CCMA/Galway County Council.

**Clients**

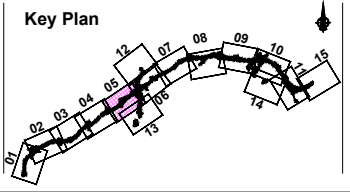

**Consultant**

Corporate House  
City East Business Park  
Ballybrit, Galway, Ireland.

Tel +353 (0)91 460675  
www.N6GalwayCity.ie  
www.arup.ie

**Job Title**  
N6 Galway City Ring Road

**Scale**  
1:5000 @ A3

**Date:**  
February 2018

Issue	Date	By	Chkd	Appd
11	22/02/2018	KJ	MG	EMC

**Drawing Title**  
Proposed Road Development Plan  
CH.5+800 to CH.7+300  
Sheet 5 of 15

**Drawing Status**  
For Information

<b>Job No</b> 233985	<b>Drawing No</b> GCOB-100-D-005	<b>Issue</b> 11
-------------------------	-------------------------------------	--------------------

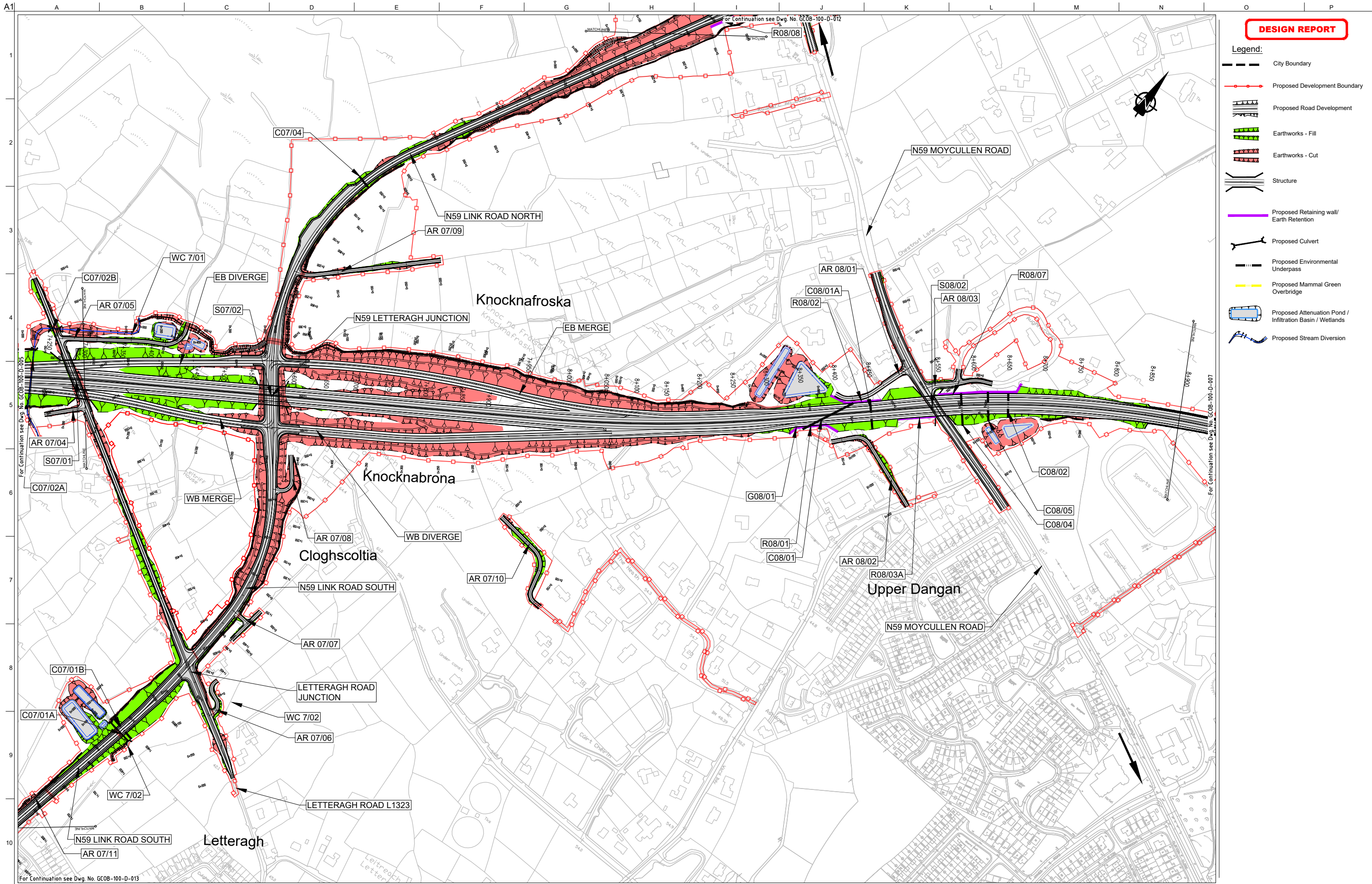

**DESIGN REPORT**

- Legend:**
- City Boundary
  - Proposed Development Boundary
  - Proposed Road Development
  - Earthworks - Fill
  - Earthworks - Cut
  - Structure
  - Proposed Retaining wall/Earth Retention
  - Proposed Culvert
  - Proposed Environmental Underpass
  - Proposed Mammal Green Overbridge
  - Proposed Attenuation Pond / Infiltration Basin / Wetlands
  - Proposed Stream Diversion

San áiríamh tá sonraíocht Shairbhíreacha Ordnáinis Éireann arna aistriú go dtailíú físiú Chaidéinis OSI Uimh. 2010/18CCMA/Comhairle Contae na Gaillimhe. Sáráilom aistriú go dtailíú na císcheart Shairbhíreacha Ordnáinis Éireann agus Rialtas na hÉireann. © Sairbhíreacha Ordnáinis Éireann, 2010.

© Sairbhíreacha Ordnáinis Éireann. Gach ceart ar chosaint.  
Uimhir cheadúnais 2010/18CCMA/Comhairle Contae na Gaillimhe.

Includes Ordnance Survey Ireland data reproduced under OSI Licence number 2010/18CCMA/Galway County Council.  
Unauthorised reproduction infringes Ordnance Survey Ireland and Government of Ireland copyright. © Ordnance Survey Ireland, 2010.

© Ordnance Survey Ireland. All rights reserved. Licence number 2010/18CCMA/Galway County Council.

Clients

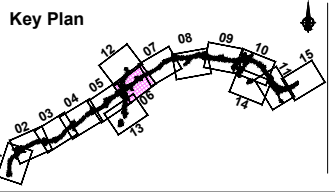

Consultant

Corporate House  
City East Business Park  
Ballybrit, Galway, Ireland.

Tel +353 (0)91 460675  
www.N6GalwayCity.ie  
www.arup.ie

Job Title  
**N6 Galway City Ring Road**

Scale  
1:5000 @ A3

Date:  
February 2018

Issue	Date	By	Chkd	Appd
11	22/02/2018	KJ	MG	EMC

Drawing Title  
Proposed Road Development Plan  
CH.7+300 to CH.8+900  
Sheet 6 of 15

Drawing Status  
**For Information**

Job No <b>233985</b>	Drawing No <b>GCOB-100-D-006</b>	Issue <b>11</b>
-------------------------	-------------------------------------	--------------------

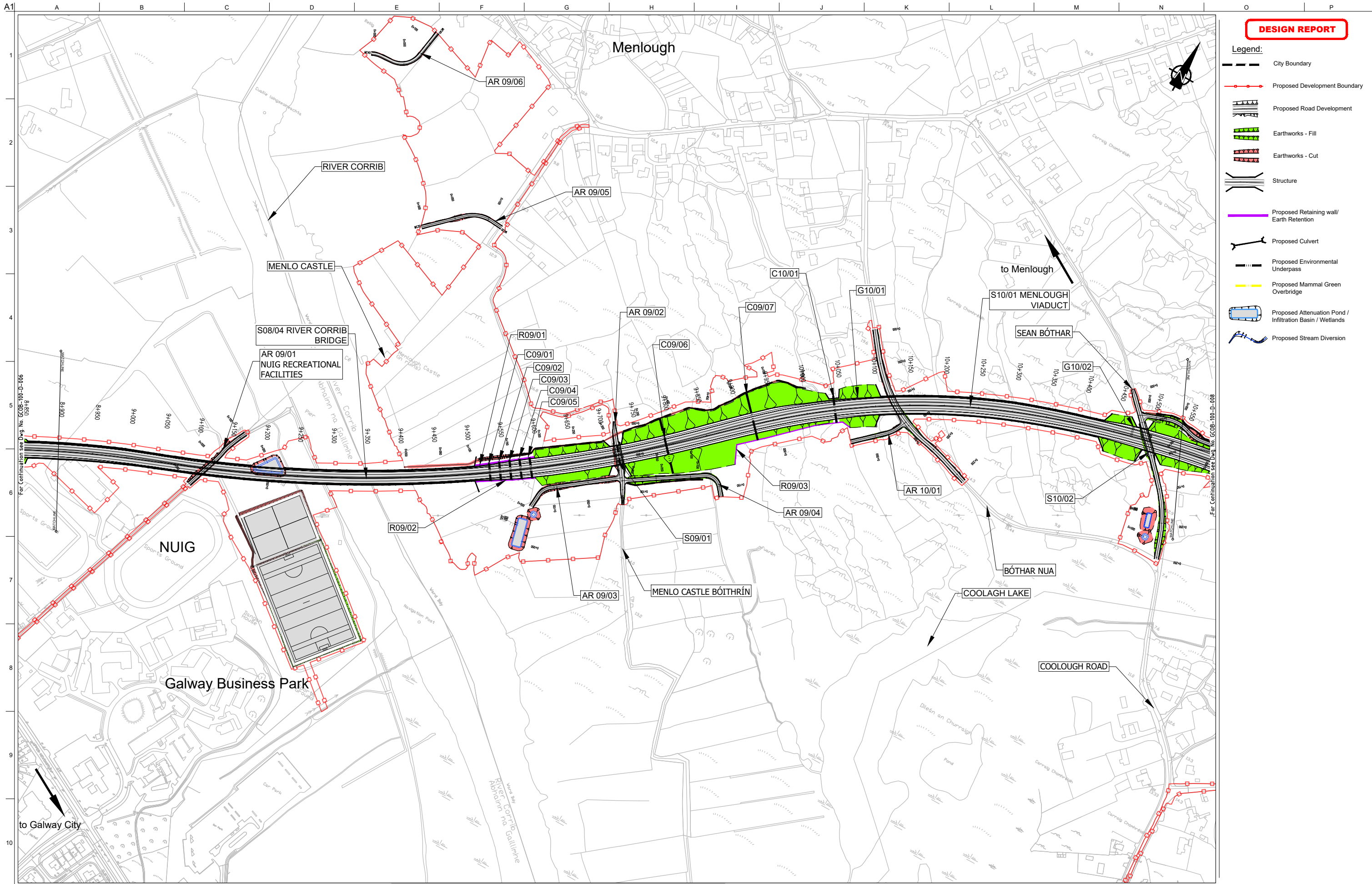

**DESIGN REPORT**

- Legend:**
- City Boundary
  - Proposed Development Boundary
  - Proposed Road Development
  - Earthworks - Fill
  - Earthworks - Cut
  - Structure
  - Proposed Retaining wall/ Earth Retention
  - Proposed Culvert
  - Proposed Environmental Underpass
  - Proposed Mammal Green Overbridge
  - Proposed Attenuation Pond / Infiltration Basin / Wetlands
  - Proposed Stream Diversion

San áiríonn sé go dtéann na sonraíochtaí Shuirbhíreacht Orlandais Éireann arís aistriúchán fíor Cheadúnas OSI Uimh. 2010/18CCMA/Comhairle Contae na Gaillimhe. Sárúilom aistriúchán na mbáid arís aistriúchán Shuirbhíreacht Orlandais Éireann agus Rialtas na hÉireann. © Suirbhíreacht Orlandais Éireann, 2010.

© Suirbhíreacht Orlandais Éireann. Gach ceart ar chosaint. Uimhir cheadúnais 2010/18CCMA/Comhairle Contae na Gaillimhe.

Includes Ordnance Survey Ireland data reproduced under OSI Licence number 2010/18CCMA/Galway County Council. Unauthorised reproduction infringes Ordnance Survey Ireland and Government of Ireland copyright. © Ordnance Survey Ireland, 2010.

© Ordnance Survey Ireland. All rights reserved. Licence number 2010/18CCMA/Galway County Council.

**Clients**

Comhairle Chontae na Gaillimhe  
Galway County Council

**Galway City Transport Project**

**An Roinn Iompair**  
Turasóireachta agus Spóirt

**TIIP**  
Bonnagar Transport Éireann

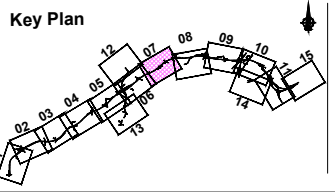

**Consultant**

**ARUP**

Corporate House  
City East Business Park  
Ballybrit, Galway, Ireland.

Tel +353 (0)91 460675  
www.N6GalwayCity.ie  
www.arup.ie

**Job Title**  
N6 Galway City Ring Road

**Scale**  
1:5000 @ A3

**Date:**  
February 2018

Issue	Date	By	Chkd	Appd
I2	12/03/2018	KJ	MG	EMC
I1	22/02/2018	KJ	MG	EMC

**Drawing Title**  
Proposed Road Development Plan  
CH.8+900 to CH.10+550  
Sheet 7 of 15

**Drawing Status**  
For Information

**Job No**  
233985

**Drawing No**  
GCOB-100-D-007

**Issue**  
12

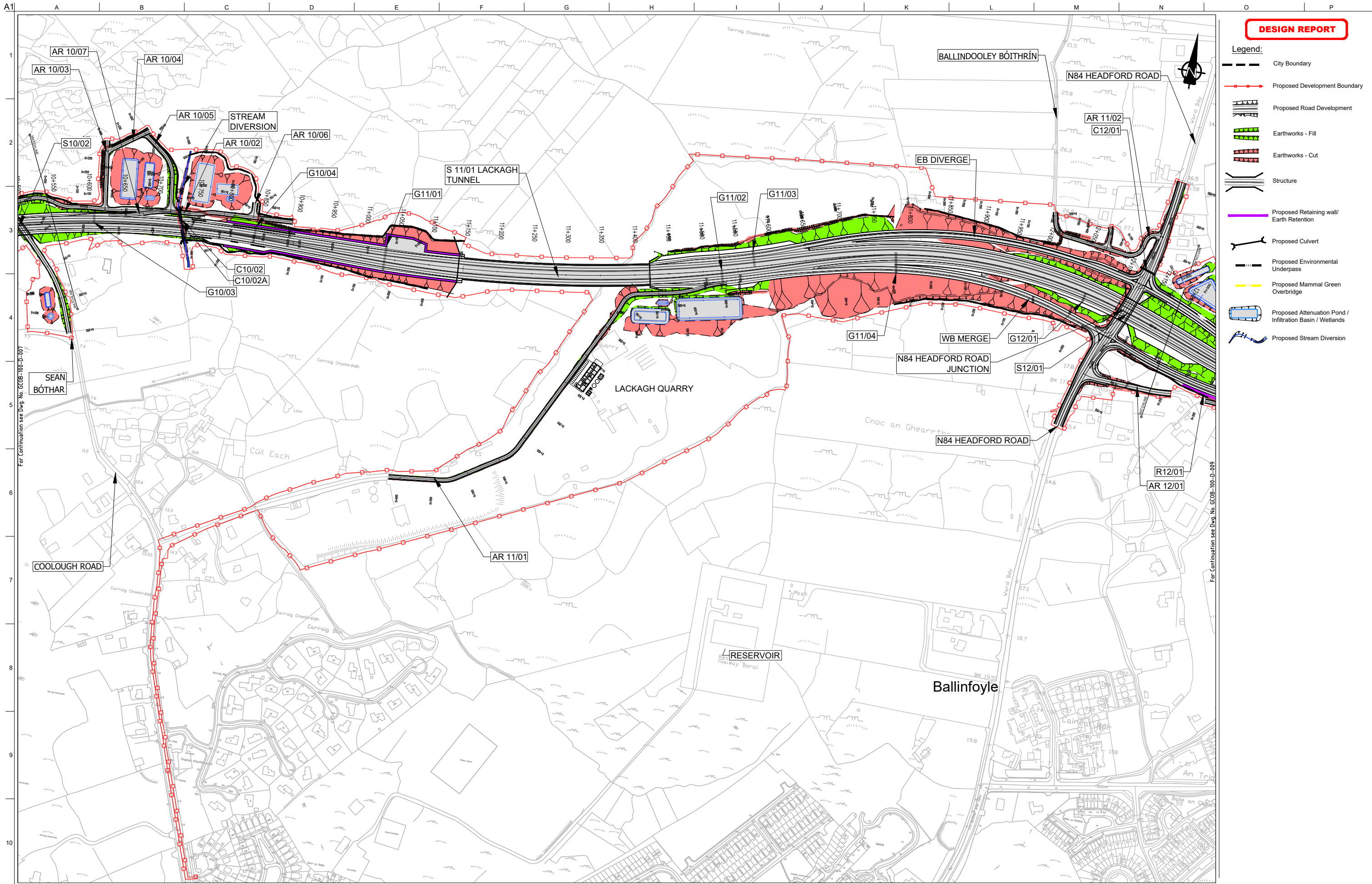

**DESIGN REPORT**

- Legend:**
- City Boundary
  - Proposed Development Boundary
  - Proposed Road Development
  - Earthworks - Fill
  - Earthworks - Cut
  - Structure
  - Proposed Retaining wall/ Earth Retention
  - Proposed Culvert
  - Proposed Environmental Underpass
  - Proposed Mammal Green Overbridge
  - Proposed Attenuation Pond / Infiltration Basin / Wetlands
  - Proposed Stream Diversion

San áiríamh tá sonraíoch Shuirbhíreacht Ordánais Éireann arna áitirgeadh faoi Cheadúnas OSI Uimh. 2010/18CCMA/Comhairle Contae na Gaillimhe. Sárúim ar áitirgeadh na mháid arís na cópáir Shuirbhíreacht Ordánais Éireann agus Rialtas na hÉireann. © Shuirbhíreacht Ordánais Éireann, 2010.

© Shuirbhíreacht Ordánais Éireann. Gach ceart ar chosaint.  
Uimhir cheadúnais 2010/18CCMA/Comhairle Contae na Gaillimhe.

Includes Ordnance Survey Ireland data reproduced under OSI Licence number 2010/18CCMA/Galway County Council.  
Unauthorised reproduction infringes Ordnance Survey Ireland and Government of Ireland copyright. © Ordnance Survey Ireland, 2010.

© Ordnance Survey Ireland. All rights reserved. Licence number 2010/18CCMA/Galway County Council.

**Clients**

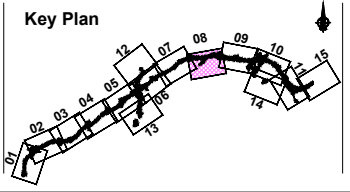

**Consultant**

Corporate House  
City East Business Park  
Ballybrit, Galway, Ireland.

Tel +353 (0)91 460675  
www.N6GalwayCity.ie  
www.arup.ie

**Job Title**  
N6 Galway City Ring Road

**Scale**  
1:5000 @ A3

**Date:**  
February 2018

Issue	Date	By	Chkd	Appd
11	22/02/2018	KJ	MG	EMC

**Drawing Title**  
Proposed Road Development Plan  
CH.10+550 to CH.12+200  
Sheet 8 of 15

**Drawing Status**  
For Information

<b>Job No</b> 233985	<b>Drawing No</b> GCOB-100-D-008	<b>Issue</b> 11
-------------------------	-------------------------------------	--------------------



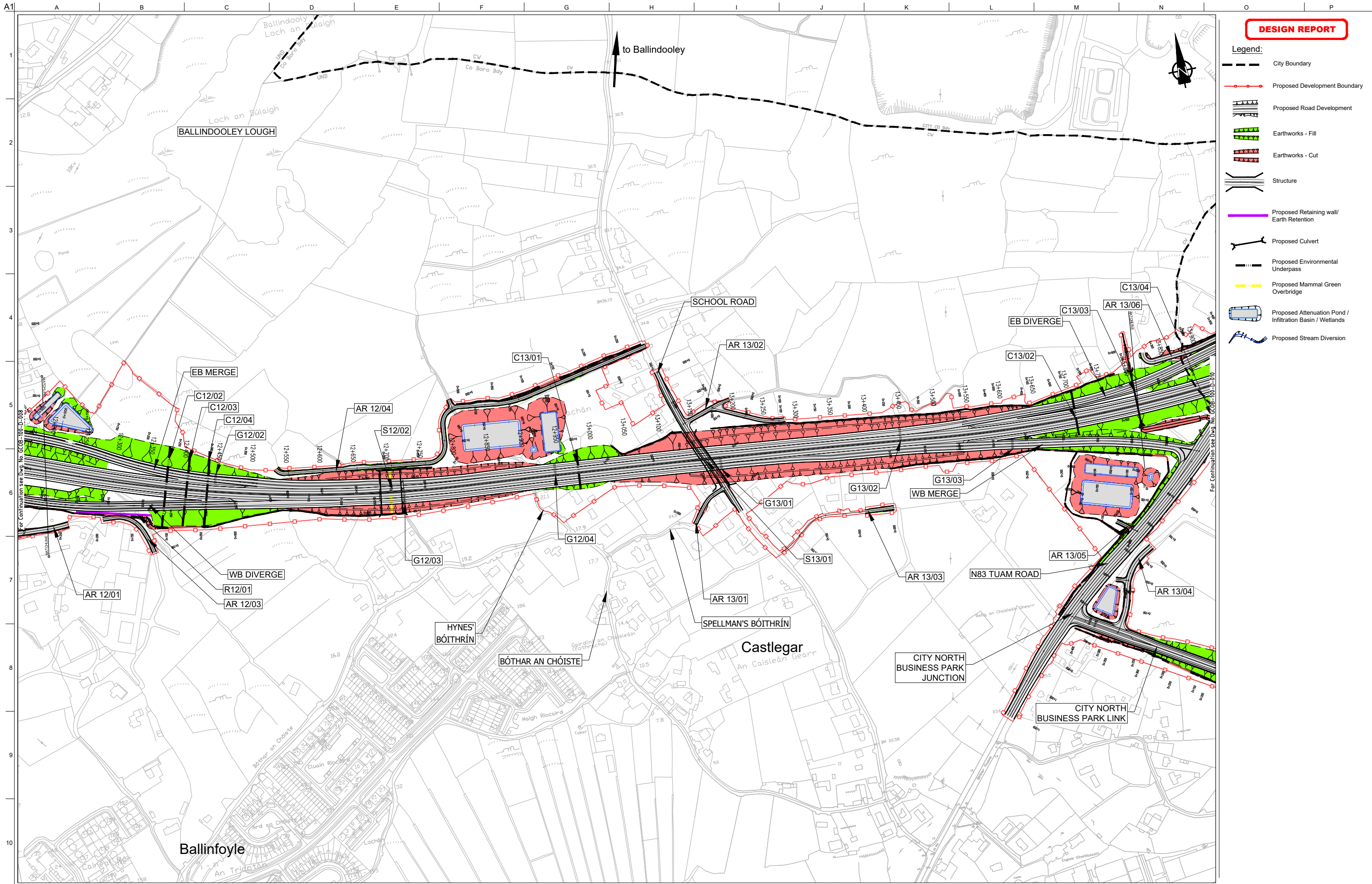

**DESIGN REPORT**

- Legend:**
- City Boundary
  - Proposed Development Boundary
  - Proposed Road Development
  - Earthworks - Fill
  - Earthworks - Cut
  - Structure
  - Proposed Retaining wall / Earth Retention
  - Proposed Culvert
  - Proposed Environmental Underpass
  - Proposed Mammal Green Overbridge
  - Proposed Attenuation Pond / Infiltration Basin / Wetlands
  - Proposed Stream Diversion

San áiríamh tá sonraíocht Shairbhíreacht Ordnáis Éireann arna aistriú go dtailíú físiúil Cheadúnas OSI Uimh. 2010/18CCMA/Comhairle Contae na Gaillimhe. Sárúimh aistriú go dtailíú físiúil Cheadúnas OSI Uimh. 2010/18CCMA/Comhairle Contae na Gaillimhe. © Sairbhíreacht Ordnáis Éireann, 2010.

© Sairbhíreacht Ordnáis Éireann. Gach ceart ar chosaint. Uimhir cheadúnais 2010/18CCMA/Comhairle Contae na Gaillimhe.

Includes Ordnance Survey Ireland data reproduced under OSI Licence number 2010/18CCMA/Galway County Council. Unauthorised reproduction infringes Ordnance Survey Ireland and Government of Ireland copyright. © Ordnance Survey Ireland, 2010.

© Ordnance Survey Ireland. All rights reserved. Licence number 2010/18CCMA/Galway County Council.

**Clients**

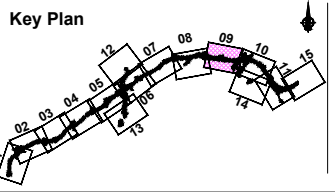

**Consultant**

Corporate House  
City East Business Park  
Ballybrit, Galway, Ireland.

Tel +353 (0)91 460675  
www.NGalwayCity.ie  
www.arup.ie

**Job Title**  
N6 Galway City Ring Road

**Scale**  
1:5000 @ A3

**Date:**  
February 2018

Issue	Date	By	Chkd	Appd
11	22/02/2018	KJ	MG	EMC

**Drawing Title**  
Proposed Road Development Plan  
CH.12+200 to CH.13+800  
Sheet 9 of 15

**Drawing Status**  
For Information

<b>Job No</b> 233985	<b>Drawing No</b> GCOB-100-D-009	<b>Issue</b> 11
-------------------------	-------------------------------------	--------------------

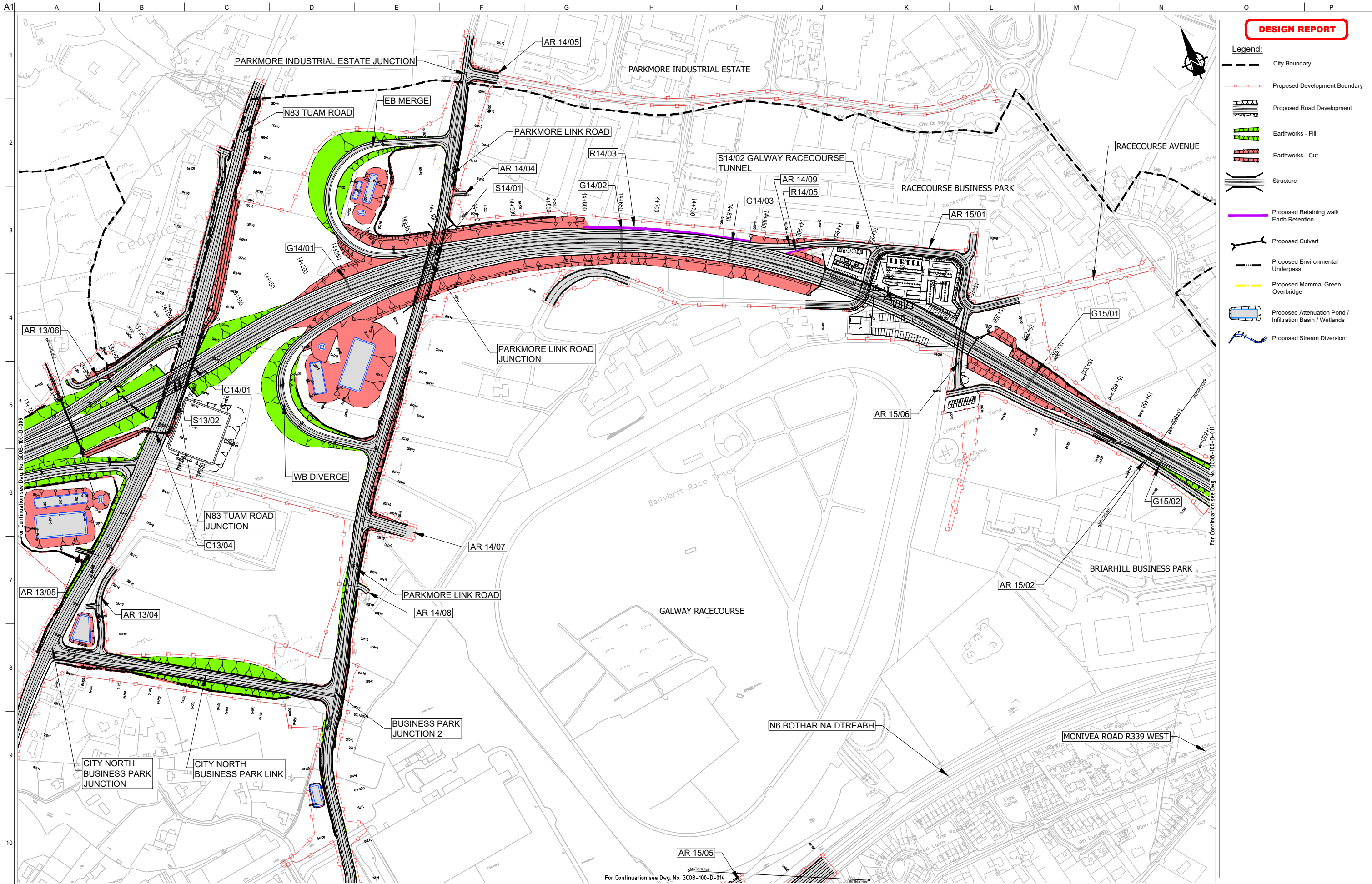

**DESIGN REPORT**

- Legend:**
- City Boundary
  - Proposed Development Boundary
  - Proposed Road Development
  - Earthworks - Fill
  - Earthworks - Cut
  - Structure
  - Proposed Retaining wall/ Earth Retention
  - Proposed Culvert
  - Proposed Environmental Underpass
  - Proposed Mammal Green Overbridge
  - Proposed Attenuation Pond / Infiltration Basin / Wetlands
  - Proposed Stream Diversion

San áiríamh tá sonraíochtaí Shairbhíreacht Ordoisín Éireann arna aistriú go dtailíú físiúil Cheadúnas OSI Uimh. 2010/18CCMA/Comhairle Contae na Gaillimhe. Sárúimh aistriú go dtailíú na cíoscheart Shairbhíreacht Ordoisín Éireann agus Rialtas na hÉireann. © Sairbhíreacht Ordoisín Éireann, 2010.

© Sairbhíreacht Ordoisín Éireann. Gach ceart ar chosaint. Uimhir cheadúnais 2010/18CCMA/Comhairle Contae na Gaillimhe.

Includes Ordnance Survey Ireland data reproduced under OSI Licence number 2010/18CCMA/Galway County Council. Unauthorised reproduction infringes Ordnance Survey Ireland and Government of Ireland copyright. © Ordnance Survey Ireland, 2010.

© Ordnance Survey Ireland. All rights reserved. Licence number 2010/18CCMA/Galway County Council.

**Clients**

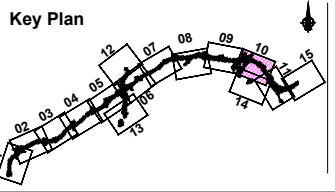

**Consultant**

Corporate House  
City East Business Park  
Ballybrit, Galway, Ireland.

Tel +353 (0)91 460675  
www.N6GalwayCity.ie  
www.arup.ie

**Job Title**  
N6 Galway City Ring Road

**Scale**  
1:5000 @ A3

**Date:**  
February 2018

Issue	Date	By	Chkd	Appd
11	22/02/2018	KJ	MG	EMC

**Drawing Title**  
Proposed Road Development Plan  
CH.13+800 to CH.15+500  
Sheet 10 of 15

**Drawing Status**  
For Information

Job No	Drawing No	Issue
233985	GCOB-100-D-010	11

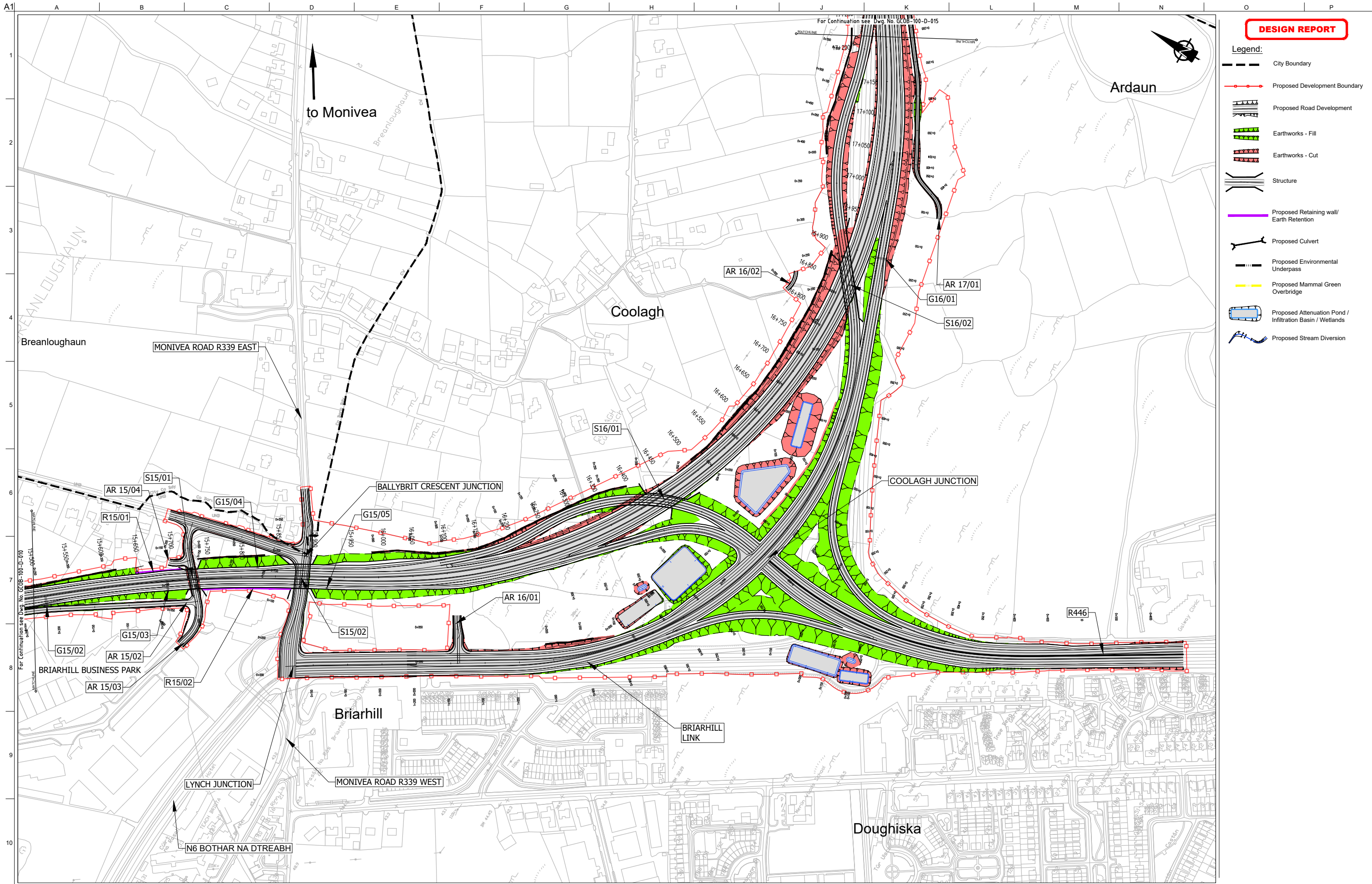

**DESIGN REPORT**

- Legend:**
- City Boundary
  - Proposed Development Boundary
  - Proposed Road Development
  - Earthworks - Fill
  - Earthworks - Cut
  - Structure
  - Proposed Retaining wall / Earth Retention
  - Proposed Culvert
  - Proposed Environmental Underpass
  - Proposed Mammal Green Overbridge
  - Proposed Attenuation Pond / Infiltration Basin / Wetlands
  - Proposed Stream Diversion

Son áiríamh tá sonraíochtaí Shairbhíreacha Orlándaís Éireann arna aistriúchadh faoi Chéadainn OSI Uimh. 2010/18CCMA/Comhairle Contae na Gaillimhe. Sáráilom aistriúchadh namháid arís na cíoscheart Shairbhíreacha Orlándaís Éireann agus Rialtas na hÉireann. © Sairbhíreacha Orlándaís Éireann, 2010.

© Sairbhíreacha Orlándaís Éireann. Gach ceart ar chosaint. Uimhir cheadainn 2010/18CCMA/Comhairle Contae na Gaillimhe.

Includes Ordnance Survey Ireland data reproduced under OSI Licence number 2010/18CCMA/Galway County Council. Unauthorised reproduction infringes Ordnance Survey Ireland and Government of Ireland copyright. © Ordnance Survey Ireland, 2010.

© Ordnance Survey Ireland. All rights reserved. Licence number 2010/18CCMA/Galway County Council.

Clients

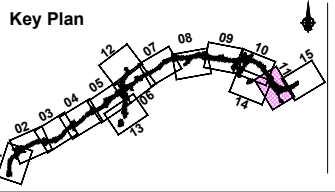

Consultant

Corporate House  
City East Business Park  
Ballybrit, Galway, Ireland.

Tel +353 (0)91 460675  
www.N6GalwayCity.ie  
www.arup.ie

Job Title  
**N6 Galway City Ring Road**

Scale  
1:5000 @ A3

Date:  
February 2018

Issue	Date	By	Chkd	Appd
11	22/02/2018	KJ	MG	EMC

Drawing Title  
Proposed Road Development Plan  
CH.15+500 to CH.17+540 ( End of Scheme )  
Sheet 11 of 15

Drawing Status  
**For Information**

Job No	Drawing No	Issue
233985	GCOB-100-D-011	11

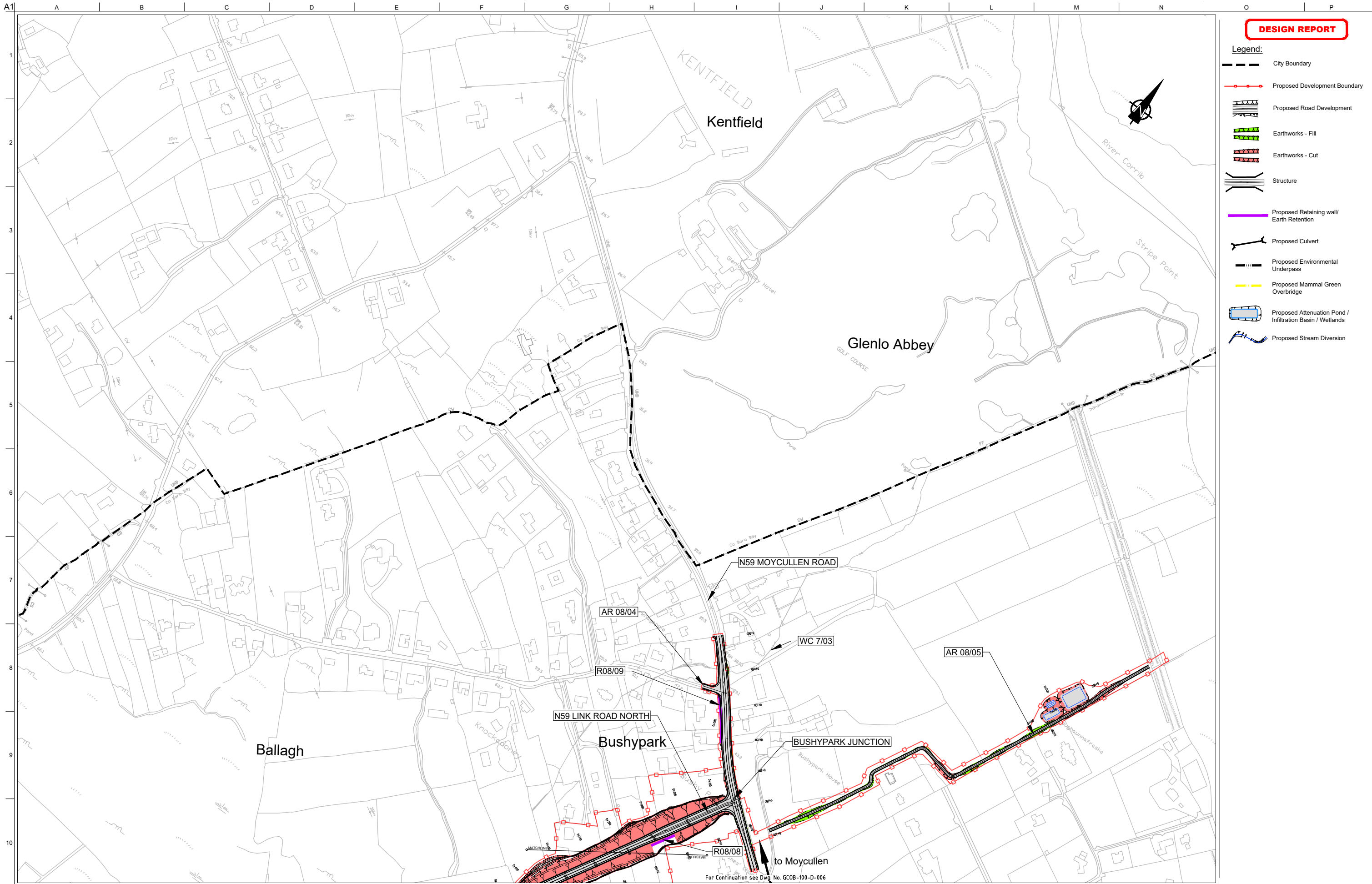

**DESIGN REPORT**

- Legend:**
- City Boundary
  - Proposed Development Boundary
  - Proposed Road Development
  - Earthworks - Fill
  - Earthworks - Cut
  - Structure
  - Proposed Retaining wall / Earth Retention
  - Proposed Culvert
  - Proposed Environmental Underpass
  - Proposed Mammal Green Overbridge
  - Proposed Attenuation Pond / Infiltration Basin / Wetlands
  - Proposed Stream Diversion

San áiríamh tá sonraíocht Shuirbhíreacht Ordnáis Éireann arna áitirgeadh faoi Cheadúnas OSI Uimh. 2010/18CCMA/Comhairle Contae na Gaillimhe. Sáráilom aithregeadh neamhdáraithe cóipeacht Shuirbhíreacht Ordnáis Éireann agus Rialtas na hÉireann. © Suirbhíreacht Ordnáis Éireann, 2010.

© Suirbhíreacht Ordnáis Éireann. Gach ceart ar chosaint. Uimhir cheadúnais 2010/18CCMA/Comhairle Contae na Gaillimhe.

Includes Ordnance Survey Ireland data reproduced under OSI Licence number 2010/18CCMA/Galway County Council. Unauthorised reproduction infringes Ordnance Survey Ireland and Government of Ireland copyright. © Ordnance Survey Ireland, 2010.

© Ordnance Survey Ireland. All rights reserved. Licence number 2010/18CCMA/Galway County Council.

**Clients**

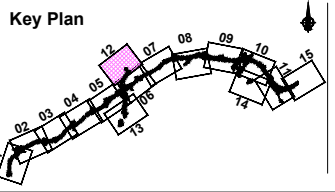

**Consultant**

Corporate House  
City East Business Park  
Ballybrit, Galway, Ireland.

Tel +353 (0)91 460675  
www.N6GalwayCity.ie  
www.arup.ie

**Job Title**  
N6 Galway City Ring Road

**Scale**  
1:5000 @ A3

**Date:**  
February 2018

Issue	Date	By	Chkd	Appd
11	22/02/2018	KJ	MG	EMC

**Drawing Title**  
Proposed Road Development Plan  
N59 Link Road North  
Sheet 12 of 15

**Drawing Status**  
For Information

<b>Job No</b> 233985	<b>Drawing No</b> GCOB-100-D-012	<b>Issue</b> 11
-------------------------	-------------------------------------	--------------------

A1  
1  
2  
3  
4  
5  
6  
7  
8  
9  
10

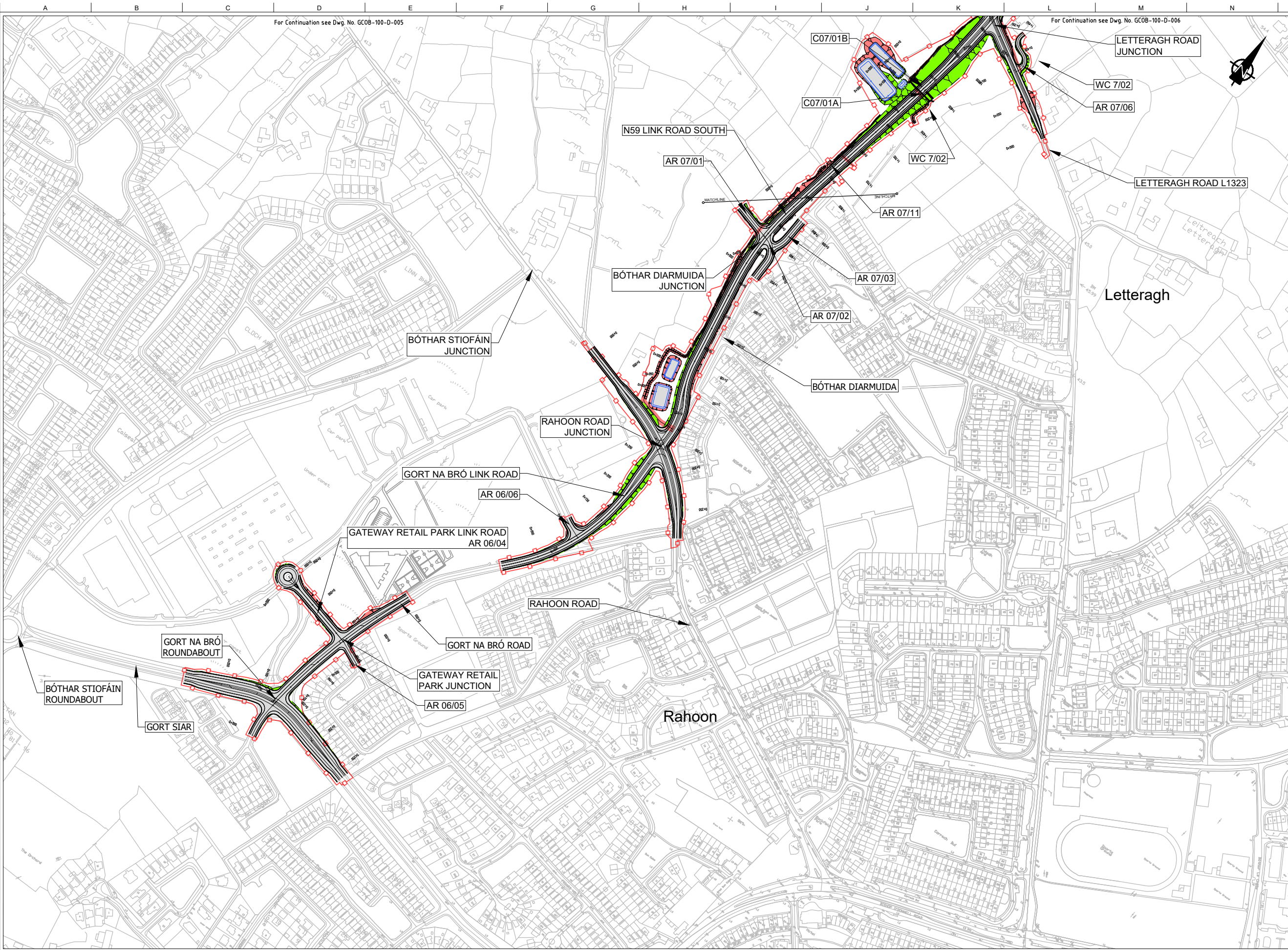

Son áireamh tá sonraíochtaí Shairbhíreacht Ordnáis Éireann arna áitirgeadh faoi Cheadúnas OSI Uimh. 2010/18CCMA/Comhairle Contae na Gaillimhe. Sáráilom áitirgeadh neamhdáraithe cóipeacht Shairbhíreacht Ordnáis Éireann agus Rialtas na hÉireann. © Sairbhíreacht Ordnáis Éireann, 2010.

© Sairbhíreacht Ordnáis Éireann. Gach ceart ar chosaint.  
Uimhir cheadúnais 2010/18CCMA/Comhairle Contae na Gaillimhe.

Includes Ordnance Survey Ireland data reproduced under OSI Licence number 2010/18CCMA/Galway County Council.  
Unauthorised reproduction infringes Ordnance Survey Ireland and Government of Ireland copyright. © Ordnance Survey Ireland, 2010.

© Ordnance Survey Ireland. All rights reserved. Licence number 2010/18CCMA/Galway County Council.

Clients

Comhairle Chontae na Gaillimhe  
Galway County Council

Galway City Transport Project

An Roinn Iompair  
Turasóireachta agus Spóirt

TII

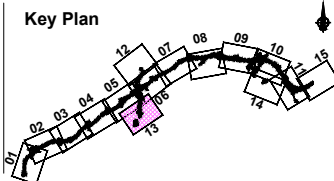

Consultant

**ARUP**

Corporate House  
City East Business Park  
Ballybrit, Galway, Ireland.

Tel +353 (0)91 460675  
www.N6GalwayCity.ie  
www.arup.ie

Job Title  
N6 Galway City Ring Road

Scale  
1:5000 @ A3

Date:  
February 2018

Issue	Date	By	Chkd	Appd
11	22/02/2018	KJ	MG	EMC

Drawing Title  
Proposed Road Development Plan  
N59 Link Road South, Gateway Retail Park Junction  
Sheet 13 of 15

Drawing Status  
For Information

Job No  
233985

Drawing No  
GCOB-100-D-013

Issue  
11

A1  
1  
2  
3  
4  
5  
6  
7  
8  
9  
10

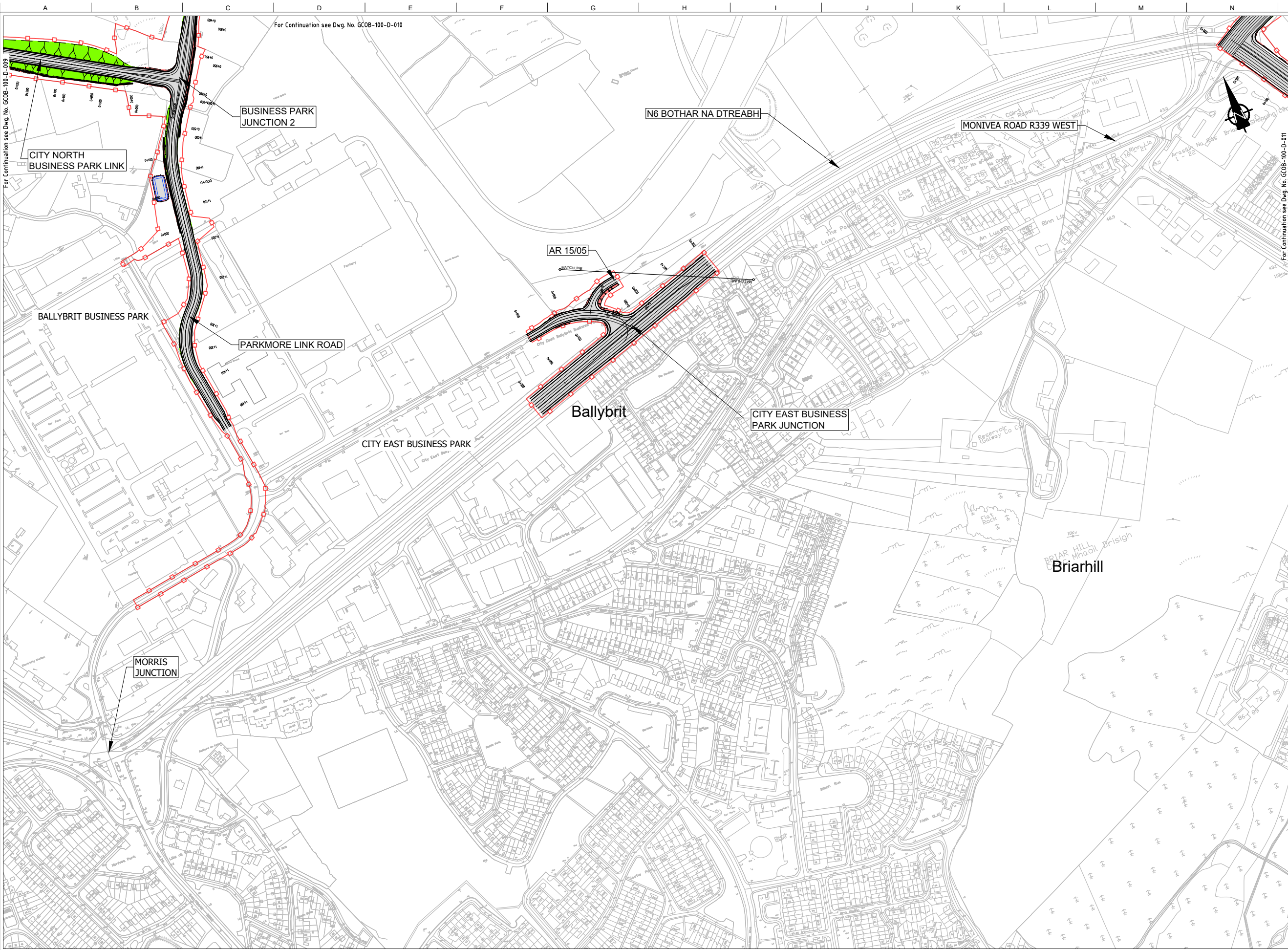

**DESIGN REPORT**

- Legend:**
- City Boundary
  - Proposed Development Boundary
  - Proposed Road Development
  - Earthworks - Fill
  - Earthworks - Cut
  - Structure
  - Proposed Retaining wall/Earth Retention
  - Proposed Culvert
  - Proposed Environmental Underpass
  - Proposed Mammal Green Overbridge
  - Proposed Attenuation Pond / Infiltration Basin / Wetlands
  - Proposed Stream Diversion

Son áiríamh tá sonraíochtaí Shairbhéiríochtaí Ordánais Éireann arna aistriú go dtailíú físiúil Cheadúnas OSI Uimh. 2010/18CCMA/Comhairle Contae na Gaillimhe. Sárúilom aistriú go dtailíú físiúil na cópáiríochtaí Shairbhéiríochtaí Ordánais Éireann agus Rialtas na hÉireann. © Sairbhéiríochtaí Ordánais Éireann, 2010.

© Sairbhéiríochtaí Ordánais Éireann. Gach ceart ar chosaint.  
Uimhír cheadúnais 2010/18CCMA/Comhairle Contae na Gaillimhe.

Includes Ordnance Survey Ireland data reproduced under OSI Licence number 2010/18CCMA/Galway County Council.  
Unauthorised reproduction infringes Ordnance Survey Ireland and Government of Ireland copyright. © Ordnance Survey Ireland, 2010.

© Ordnance Survey Ireland. All rights reserved. Licence number 2010/18CCMA/Galway County Council.

**Clients**

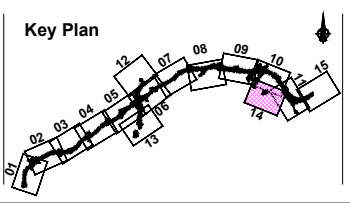

**Consultant**

Corporate House  
City East Business Park  
Ballybrit, Galway, Ireland.

Tel +353 (0)91 460675  
www.N6GalwayCity.ie  
www.arup.ie

**Job Title**  
N6 Galway City Ring Road

**Scale**  
1:5000 @ A3

**Date:**  
February 2018

Issue	Date	By	Chkd	Appd
11	22/02/2018	KJ	MG	EMC

**Drawing Title**  
Proposed Road Development Plan  
City East Junction  
Sheet 14 of 15

**Drawing Status**  
For Information

<b>Job No</b> 233985	<b>Drawing No</b> GCOB-100-D-014	<b>Issue</b> 11
-------------------------	-------------------------------------	--------------------

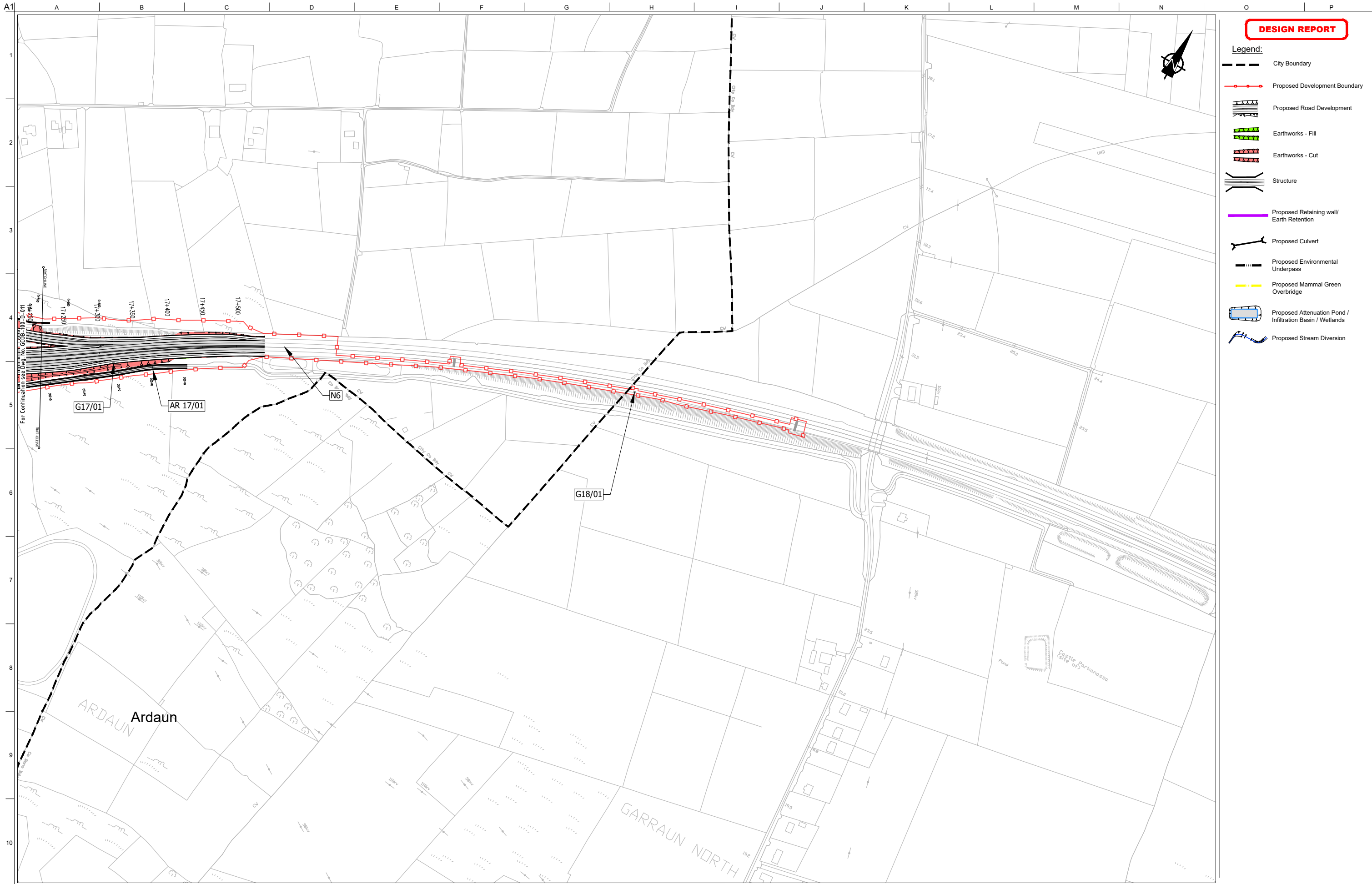

**DESIGN REPORT**

- Legend:**
- City Boundary
  - Proposed Development Boundary
  - Proposed Road Development
  - Earthworks - Fill
  - Earthworks - Cut
  - Structure
  - Proposed Retaining wall/ Earth Retention
  - Proposed Culvert
  - Proposed Environmental Underpass
  - Proposed Mammal Green Overbridge
  - Proposed Attenuation Pond / Infiltration Basin / Wetlands
  - Proposed Stream Diversion

San áiríamh tá sonraíochtaí Shuirbhéireacht Ordnáis Éireann arna atáirgeadh faoi Chreadúnas OSI Uimh. 2010/18CCMA/Comhairle Contae na Gaillimhe. Sáráilom atáirgeadh neamhdáraithe cóipeacht Shuirbhéireacht Ordnáis Éireann agus Rialtas na hÉireann. © Suirbhéireacht Ordnáis Éireann, 2010.

© Suirbhéireacht Ordnáis Éireann. Gach ceart ar chosaint.  
Uimhir cheadúnais 2010/18CCMA/Comhairle Contae na Gaillimhe.

Includes Ordnance Survey Ireland data reproduced under OSI Licence number 2010/18CCMA/Galway County Council.  
Unauthorised reproduction infringes Ordnance Survey Ireland and Government of Ireland copyright. © Ordnance Survey Ireland, 2010.

© Ordnance Survey Ireland. All rights reserved. Licence number 2010/18CCMA/Galway County Council.

Clients

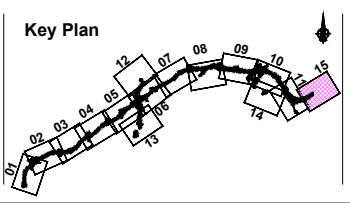

Consultant

Corporate House  
City East Business Park  
Ballybrit, Galway, Ireland.

Tel +353 (0)91 460675  
www.N6GalwayCity.ie  
www.arup.ie

Job Title  
**N6 Galway City Ring Road**

Scale  
1:5000 @ A3

Date:  
February 2018

Issue	Date	By	Chkd	Appd
11	22/02/2018	KJ	MG	EMC

Drawing Title  
**Proposed Road Development Plan  
CH.17+540 ( End of Scheme ) to Existing N6 (~CH.18+550)  
Sheet 15 of 15**

Drawing Status  
**For Information**

Job No <b>233985</b>	Drawing No <b>GCOB-100-D-015</b>	Issue <b>11</b>
-------------------------	-------------------------------------	--------------------